

EXTENDA-BAN VALVE REPAIR AND MAINTENANCE

1 Detach the Valve and Extension from the hose. Carefully remove the mesh strainer. Squeeze the Trigger to drain all liquid from the Valve.

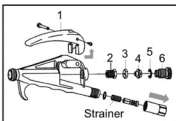

2 Remove the Trigger (1), then the Snap ring (5), Safety lock nut (6), the Adjustment screw (4), the Lock nut (3), and then the Packing nut (2). The Trigger can be removed by moving it to the back of the Valve.

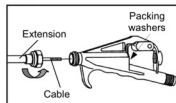

3 Unscrew the extension at the front of the valve. The extension can be pulled away from the valve along with the interior steel cable.

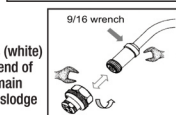

4 Packing washers (white) that were at the end of the cable will remain inside the valve. Carefully dislodge and remove these washers.

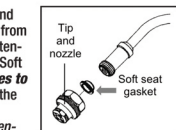

5 Remove the tip and nozzle assembly from the end of the extension, be careful to keep the Soft seat gasket. **Use 2 wrenches to loosen the tip:** one to hold the extension, and a second to loosen the tip. *Note: the extension may become twisted and unusable unless 2 wrenches are used to remove the tip.* Inspect the soft seat gasket and the small O-ring on Multeejet tips, replace if damaged or worn. Replace the nozzle if it is more than 2 years old.

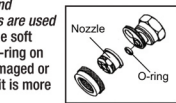

6 Push the cable out the front of the Extension to expose the Spring, the small Lock nut, and the Seat stem. Unscrew the Seat stem and Lock nut, and slide off the Spring. Place these small pieces in a closed container (they are easily misplaced).

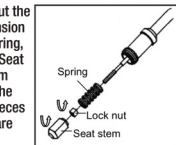

7 Remove the stainless steel cable by pulling it slowly through the **back end of the Extension** - you cannot pull the cable through the front of the Extension. The threaded end of the cable at the nozzle end is short and easily passes through the curve in the Extension. The end of the cable at the valve end is long and will not pass through the curve. Replace the cable if it is worn or damaged.

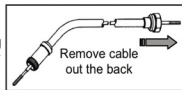

8 Re-assemble the Extension by inserting the short end of the cable into the back so that threads are exposed at the nozzle end.

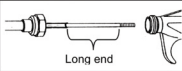

9 Slide the Spring onto the end of the cable, then the Seat stem lock nut. Screw lock nut to leave **about 4 threads** at the base of the end of the cable.

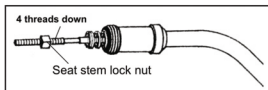

10 Attach the Seat stem onto the cable, in front of the Lock nut. Hand tighten Seat stem against the lock nut.

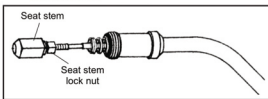

11 Insert the long end of the cable into the front end of the valve. Push the cable through the valve until the end is through the back of the valve. Tighten Extension to the valve body.

